

REWITNESSED CORNER FOR STATE OF OREGON - DEPARTMENT OF FORESTRY

Section corner common to Sections 1, 6, 31 and 36, T1&2S, R6&7W, W.M., Tillamook and Washington Counties, Oregon.

REWITNESSED October 6, 1988

Var. 21 1/2 E

From above pipe with marks "LS1998 1988" added, and from which
a:

- 8" Fir bears N56 1/2W 42.5 ft. to face; scribed T1SR7WS36BT.
- 12" Fir bears N42E 23.7 ft. to face; scribed T1SR6WS31BT.
- 10" Fir bears S72E 22.6 ft. to face; scribed T2SR6WS6BT.
- 12" Fir bears S32W 26.9 ft. to face; scribed T2SR7WS1BT.

Metal location poster on new BTs.

Also 1956 B.L.M. metal location posters on 48" Hemlock stub and 36" Fir stump BTs.

Also 1952 O.S.B.F. metal location poster on 66" Fir stump BT.

3/4" brass washer marked "LS1998" nailed to face of new BTs.

Present and witnessed by Clifford R. Foster.

Restored by David B. Buchholz under my direction.
David B. Buchholz, LS2272

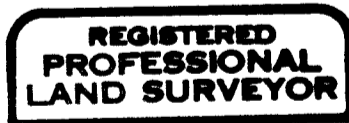
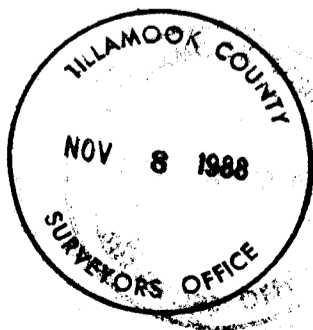

Anthony J. Klosterman

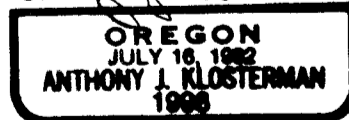

4907 Third St.,
Tillamook, Oregon 97141
Page 2